

2.0E LVL DOUBLE LEDGER ALLOWABLE LOADS & MINIMUM BEARING LENGTHS

DEFLECTION LIMITED TO L/360 OR 1/4" MAX.

2.0E LVL ALLOWABLE LOADS AND MINIMUM BEARING LENGTHS—DOUBLE LEDGER

Span [ft]	Condition	DOUBLE 1½" LEDGER					DOUBLE 1¾" LEDGER					DOUBLE 2¼" LEDGER					DOUBLE 2½" LEDGER				
		Depth [in]					Depth [in]					Depth [in]					Depth [in]				
		5½	6½	7¼	9¼	11¼	5½	6½	7¼	9¼	11¼	5½	6½	7¼	9¼	11¼	5½	6½	7¼	9¼	11¼
6	Conc + DL [plf]	509	843	1171	2436	3568	594	983	1366	2841	4162	764	1264	1756	3653	5352	849	1404	1951	4059	5946
	Total Load [plf]	1137	1537	1872	2867	3568	1327	1793	2184	3344	4162	1706	2306	2807	4300	5352	1896	2562	3119	4778	5946
	Min. Bearing [in]	3	3	3	4	5	3	3	3	4	5	3	3	3	4	5	3	3	3	4	5
7	Conc + DL [plf]	319	529	735	1531	2759	372	617	858	1786	3218	479	793	1103	2297	4138	532	881	1225	2552	4598
	Total Load [plf]	835	1128	1374	2131	3033	974	1316	1603	2486	3538	1252	1692	2060	3197	4549	1391	1880	2289	3552	5055
	Min. Bearing [in]	3	3	3	3½	5	3	3	3	3½	5	3	3	3	3½	5	3	3	3	3½	5
8	Conc + DL [plf]		330	460	959	1729	232	385	536	1119	2018	298	495	689	1438	2594	331	550	766	1598	2882
	Total Load [plf]		862	1050	1630	2320	744	1006	1225	1902	2707	957	1294	1575	2445	3480	1063	1437	1751	2717	3867
	Min. Bearing [in]		3	3	3	4-1/4	3	3	3	3	4-1/4	3	3	3	3	4-1/4	3	3	3	3	4-1/4
9	Conc + DL [plf]		204	285	596	1076		238	332	695	1256		306	427	894	1614	204	340	475	993	1794
	Total Load [plf]		680	829	1286	1831		794	967	1501	2136		1021	1243	1930	2747	839	1134	1381	2144	3052
	Min. Bearing [in]		3	3	3	3-3/4		3	3	3	3-3/4		3	3	3	3-3/4	3	3	3	3	3-3/4
10	Conc + DL [plf]				389	703			216	453	820			277	583	1055			220	308	648
	Total Load [plf]				1041	1482			782	1214	1729			1005	1561	2222			917	1117	1734
	Min. Bearing [in]				3	3-1/2			3	3	3-1/2			3	3	3-1/2			3	3	3-1/2
11	Conc + DL [plf]				263	477				307	557				395	716				207	438
	Total Load [plf]				859	1223				1002	1427				1288	1834				921	1431
	Min. Bearing [in]				3	3-1/4				3	3-1/4				3	3-1/4				3	3-1/4
12	Conc + DL [plf]					335				214	390				275	502				306	558
	Total Load [plf]					1026				841	1197				1081	1539				1201	1710
	Min. Bearing [in]					3				3	3				3	3				3	3

Notes:

1. Table values are for beam orientation.
2. Span is measured from center to center of supports.
3. Table values for Conc + DL (concrete plus dead load) are limited by deflection equal to the lesser of 1/4 inch or span/360.
4. Table values have been adjusted by $C_M = 0.90$ for unprotected use. Total Load has also been adjusted by $C_D = 1.25$ for construction load duration.
5. Use sizing software or consult a professional engineer when loading is not uniform or when design conditions are otherwise outside the scope of this table.

HOW TO USE THESE TABLES:

1. Determine the Conc + DL (concrete plus dead load) and Total Load in pounds per lineal foot (plf) that must be supported by the formwork. Neglect ledger weight.
2. Select a table that matches the ledger under consideration.
3. Select a span from the first column.
4. Scan across the table for a pair of Conc + DL and Total Load values that exceed the design requirements identified in Step 1. If none are found, choose a wider ledger and return to Step 2.
5. Support across the full width of the ledger is required. Verify that the required Min. Bearing length can be provided. If not, consider a wider ledger and return to Step 2.
6. Select the ledger depth at the top of the column that satisfies the criteria provided by Steps 4 and 5.

WALL AND COLUMN FORMS

TYPICAL WALL FORM ASSEMBLY

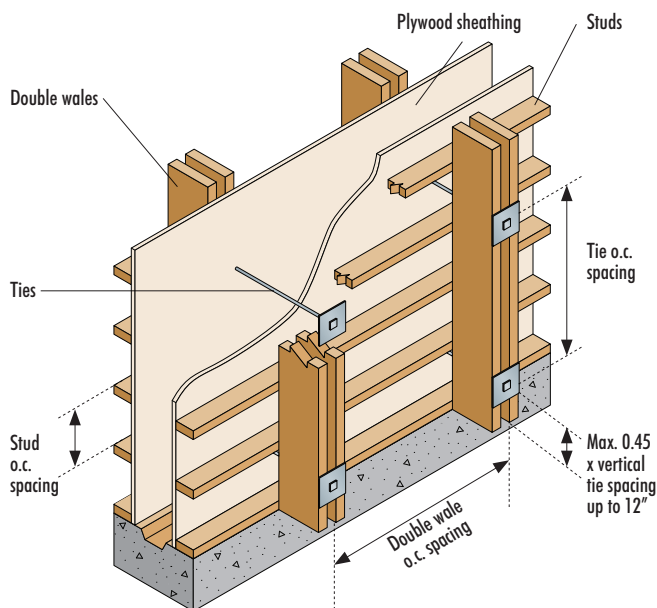

DOUBLE WALE ASSEMBLY FOR WALL APPLICATIONS

